

GSDC OF GC
Mrs. Janet Wurzelbacher
P.O. BOX 13333
HAMILTON, OH. 45013



PREMIUM LIST

#2009173901 #2009173903

#2009173902 #2009173904

AKC GSD SPECIALTY
(AKC Licensed - Unexamined)

AKC ALL BREED OBEDIENCE
AKC ALL BREED RALLY TRIAL
JR. SHOWMANSHIP
(SATURDAY PM ONLY)

PRESENTED BY
THE GERMAN SHEPHERD DOG CLUB

2 shows 1 day



GSD Specialty

2 shows 1 day

OF GREATER CINCINNATI

BLUE RIBBON DOG TRAINING ACADEMY LLC
3548 JACKSON PIKE
WILLIAMSBURG, OH. 45176
www.BlueRibbonDogTraining.com

FRIDAY, MAY 28, 2010 – OBEDIENCE & RALLY
SATURDAY, MAY 29, 2010 – CONFORMATION AM & PM
SATURDAY, MAY 29, 2010 OBEDIENCE & RALLY

Friday Obedience & Rally Entries Not to
Exceed 8 hours of Judging

BREED RING OUT DOORS
OBEDIENCE / RALLY RING INDOORS
SHOW HOURS
FRIDAY 11:00 AM TO 10:00 PM
SATURDAY 8:00 AM TO 8:00 PM

BREEDS OMITTED:

Friday: Obedience / Rally -- Poodles - Toy Poodles
Saturday: Obedience / Rally -- Poodles - Toy Poodles

ENTRY FEE: Includes \$2.50 AKC Recording Fee. \$25.00 for the first entry of each dog
in all Regular Classes, Except Puppy Classes, and Non-Regular class which
are \$15.00 and \$15.00 for each additional entry of same dog.
JUNIOR SHOWMANSHIP FEE IS \$5.00 IF DOG IS NOT ENTERED IN ANOTHER CLASS

MAKE CHECKS AND MONEY ORDERS PAYABLE TO:

THE GERMAN SHEPHERD DOG CLUB OF GREATER CINCINNATI

MAIL ALL ENTRIES WITH FEES TO:

Mrs. Janet Wurzelbacher
P.O. BOX 13333
HAMILTON, OH. 45013

FIRST CLASS

DATED MATERIAL

ENTRIES CLOSE - WEDNESDAY, 5:00 P.M. - MAY 12, 2010

OFFICERS

President Miss Dottie Bowman
513-625-4149
Vice President Mr. Ed Wessler
Treasurer Mrs. Carol Riegret
Recording Secretary Mrs. Janet Wurzelbacher
Corresponding Secretary Mrs. Judy Budnik
2948 Rontina Drive, Goshen, Ohio 45122

ENTRIES CLOSE - WEDNESDAY, 5:00 P.M. - MAY 12, 2010

HOTELS & MOTELS THAT WILL ACCEPT DOGS

(CONTACT INDIVIDUAL HOTELS FOR PET POLICY)

CLEAN UP AFTER YOUR DOGS. NO GROOMING IN ANY ROOM.

SHOW COMMITTEE

Mrs. Janet Wurzelbacher (513-385-6666)
Show Secretary / Chairman
All Officers & Club Members

BOARD OF DIRECTORS

Kim Weber Jim Budnik
Kath Cook Joyce Dougherty

Obedience Chairman.....Carol Pfitzmeier
Rally Chairman..... Kath Cook
Trophy Chairman.....Kim Weber
Chief Ring Stewart.....Dick Wurzelbacher
Ground Chairman.....Ed Wessler

Show Veterinarian (on call)

Lifetime Pet Center
3070 Williamsburg-Batavia Pike, Batavia, OH 45103
1-513-724-2688



JUDGES



Saturday AM -- Breed.....(GSD Only)
Vicki Roye
3330 Wakefield Road, Coldwater, MS, 38618

Friday -- Obedience.....(All Breed)
Janet Lewis
7269 Loop Road, Huntingdonl, PA, 16652

Friday -- Rally.....(All Breed)
Janet Lewis
7269 Loop Road, Huntingdonl, PA, 16652

Saturday PM -- Breed & Junior Showmanship.....(GSD Only)
Evan Ginsburg,
14823 Las Tunas Drive, Hacienda Heights, CA, 91745

Saturday -- Obedience.....(All Breed)
~~Richard Mullen~~
2478 Drinnen Road, Knoxville, TN, 37614

Frank Nemeth
3219 Friar Dr.
Cleveland, OH 44134-5516

Saturday -- Rally.....(All Breed)
Katie Maess
8872 Snider Road, Mason, Oh, 45040-9275

RED ROOF INN

I-275 & Rt. 125
(Exit 65)
1-513-528-2741 or
1-800-733-7663

DAYS INN EAST

I-275 & Rt. 125
(Exit 65)
1-513-528-3800
1-800-329-7466
\$10.00 per dog, per night

HOLIDAY INN

I-275 & Rt. 32
(Exit 63B)
1-513-752-4400
1-800-465-4329

MOTEL 6

I-275 & Rt. 125
(Exit 65)
1-153-752-2262
1-800-466-8356

AMERISTAY

2188 Winemiller Ln, Batavia OH
(Off Rt. 32 at Bauer Road)
1-513-735-4678

PHOTOGRAPHER

Douglas Walker
2237 Siesta Dr.
Batavia, Oh, 45103
513-266-7070
www.dwfineart.com

Judge Change

Directions to the show site

ENTRIES CLOSE -- WEDNESDAY, 5:00 P.M. - MAY 12, 2010

We're located on the eastern side of Cincinnati, convenient to SR 32, SR 133, SR 68, and I-275

From I-275: Exit 63B (East 32/Batavia) 13 miles to SR 133 (Williamsburg). North (left turn) on SR 133 to Jackson Pike (Flashing yellow light). Turn right (East) on Jackson Pike. Location is ½ mile on the left.

From the North traveling South on I-71 take Exit # 50 (SR 68) turn left on SR 68. Stay on SR 68 until you come to SR 50. (Fayetteville) turn right, 8 miles to SR 133 (Williamsburg). Turn left (South) on SR 133 to Jackson Pike (Flashing yellow light). Turn left (East) on Jackson Pike. Location is ½ mile on the left

The building sets back off of the road. The grounds are used for tracking and other training. Designated "potty" areas will be designated and marked. Use these areas only to exercise your dogs! And PLEASE pick up after your dog.

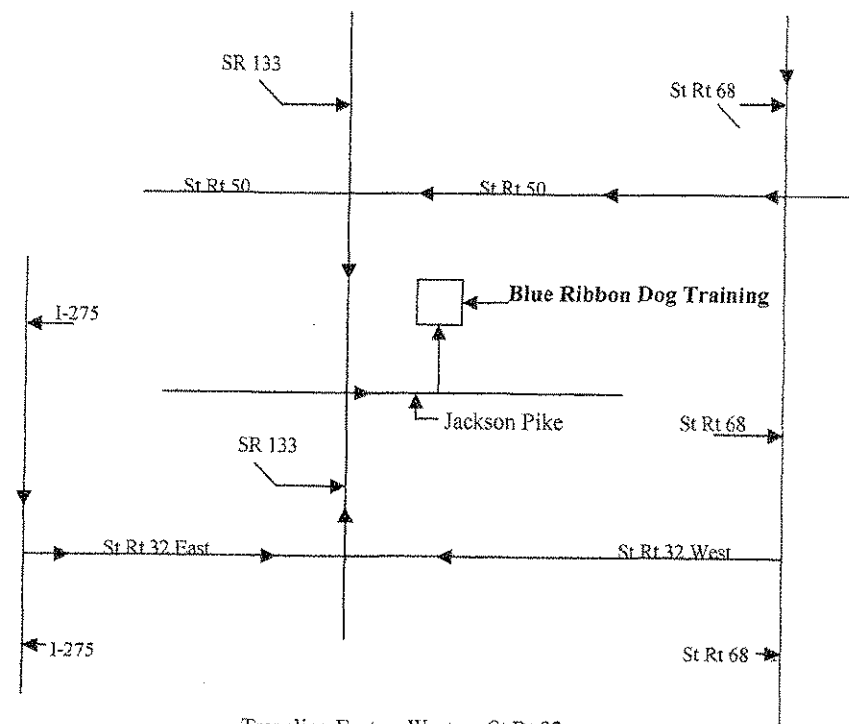

AMERICAN KENNEL CLUB CERTIFICATION

PERMISSION HAS BEEN GRANTED BY THE AMERICAN KENNEL CLUB FOR THE HOLDING OF THIS EVENT UNDER AMERICAN KENNEL CLUB RULES AND REGULATIONS.

JAMES P. CROWLEY, SECRETARY

CLASSIFICATIONS

PUPPY DOGS, 6-9 MONTHS • PUPPY DOGS, 9-12 MONTHS • DOGS, 12-18 MONTHS
NOVICE DOGS • AMATEUR OWNER HANDLER • BRED BY EXHIBITOR
AMERICAN BRED DOGS • OPEN DOGS • WINNERS DOG

(SAME CLASSES FOR BITCHES)

NON-REGULAR CLASSES
VETERAN DOG & VETERAN BITCH CLASSES

BEST OF BREED COMPETITION
BEST IN PUPPY CLASS

(Best Puppy is determined from the 6-9 and 9-12 month classes only)

OBEDIENCE (ALL BREED) **FRIDAY**

NOVICE A ---- NOVICE B ---- OPEN A ---- OPEN B ---- UTILITY A ---- UTILITY B

OBEDIENCE (ALL BREED) **SATURDAY**

NOVICE A ---- NOVICE B ---- OPEN A ---- OPEN B ---- UTILITY A ---- UTILITY B

(OPTIONAL CLASSES -- GRADUATE NOVICE • GRADUATE OPEN • VERSATILITY)
(NON-REGULAR CLASSES -- PRE-NOVICE • VETERANS)

RALLY (ALL BREED) **FRIDAY & SATURDAY**

NOVICE A / B • ADVANCED A / B • EXCELLENT A / B

JUNIOR SHOWMANSHIP COMPETITION

(SATURDAY PM SHOW ONLY)

NOVICE, INTERMEDIATE, OPEN JUNIOR CLASSES • NOVICE, INTERMEDIATE, OPEN SENIOR CLASSES

RIBBON PRIZES

REGULAR CLASSES

First Prize Blue Ribbon
Second Prize Red Ribbon
Third Prize Yellow Ribbon
Fourth Prize White Ribbon

NON-REGULAR CLASSES

First Prize Rose Ribbon
Second Prize Brown Ribbon
Third Prize Light Green Ribbon
Fourth Prize Gray Ribbon

Winners Purple Ribbon
Reserve Winners Purple & White Ribbon
Best of Winners Blue & White Ribbon
Best of Breed Purple & Gold Ribbon
Best of Opposite Sex to Best of Breed Red & White Ribbon
Highest Scoring Dog in Regular Classes Blue & Gold Ribbon
Highest Combined Scoring Dog in Trial Blue & Green Ribbon
All Qualifying Scores in Regular Obedience Classes Dark Green Ribbon
All Qualifying Scores in Regular Rally Classes Dark Green Ribbon
Best Puppy Dark Green Rosette

ENTRIES CLOSE -- WEDNESDAY, 5:00 P.M. -- MAY 12, 2010

BREED PRIZES

BEST OF BREED- BRONZE MEDAL OFFERED BY THE GERMAN SHEPHERD DOG CLUB OF AMERICA, INC
BEST OF BREED-..... A 7x9 WOOD PLAQUE WITH A METAL GRAPHIC GSD ON A GOLD PLATE
BEST OF OPPOSITE SEX -TO THE BEST OF BREED-.....
.....A 5x7 WOOD PLAQUE WITH A METAL GRAPHIC GSD ON A GOLD PLATE
BEST OF WINNERS MEDALLION
WINNERS DOG MEDALLION
WINNERS BITCH MEDALLION
RESERVE WINNERS DOG MEDALLION
RESERVE WINNERS BITCH MEDALLION
BEST PUPPYA5x7 WOOD PLAQUE WITH A METAL GRAPHIC GSD ON A GOLD PLATE
1st PLACE REGULAR CLASSES..... MEDALLION

Qualifying Score required for all Prizes in a Regular Class
The Award for Highest Scoring Dog in the Regular Classes. "Dog" means either sex.

GSD ONLY -- OBEDIENCE PRIZES

HIGHEST SCORING DOG IN THE REGULAR CLASSES --- \$15.00
1st PLACE IN EACH REGULAR CLASS -- MEDALLION

HIGHEST COMBINED SCORE IN THE OPEN B AND UTILITY CLASSES -- \$15.00
And a Bronze Medal offered by The German Shepherd Dog Club of America, Inc.

ALL BREED -- OBEDIENCE PRIZES

HIGHEST SCORING DOG IN THE REGULAR CLASSES --- \$25.00

HIGHEST COMBINED SCORE IN THE OPEN B AND UTILITY CLASSES -- \$25.00

A Dark Green Qualifying Score Ribbon will be awarded to each dog receiving a qualifying score.

GSD ONLY -- RALLY PRIZES

1st place in each classMedallion

ALL BREED -- RALLY PRIZES

A Dark Green Qualifying Score Ribbon will be awarded to each dog receiving a qualifying score.

RING RENTAL WILL BE AVAILABLE FOR OBEDIENCE / RALLY

CONTACT **KATH COOK** FOR DETAILS -- 513-724-2569
OR
kath@obevdog.com

ENTRIES CLOSE -- WEDNESDAY, 5:00 P.M. -- MAY 12, 2010

THE GERMAN SHEPHERD DOG CLUB OF GREATER CINCINNATI, INC OFFERS ALL PRIZES. THE GENEROUS DONORS WILL BE GRACIOUSLY ACKNOWLEDGED IN THE SHOW CATALOG.

Entry Fees

First entry	\$25.00
Additional entry of same dog	\$15.00
Puppy classes (6-9 & 9-12)	\$15.00
Veterans (breed)	\$15.00
Non-Regular Obedience classes	\$15.00

PLEASE NOTE: Rally is a separate event and not considered as an additional entry.
Rally entry fee \$25.00
Additional entry of same dog \$15.00

Junior Showmanship fee is \$5.00 if dog is not entered in another class

NOTICE TO EXHIBITORS ----- MOVE-UPS

OBEDIENCE & RALLY THE MOVE-UP REQUEST MUST BE PRESENTED TO THE SUPERINTENDENT /TRIAL SECRETARY IN WRITING AT LEAST 30 MINUTES PRIOR TO THE START OF THE TRIAL

CONFORMATION DOGS WHICH ACCORDING TO THEIR OWNERS RECORDS HAVE COMPLETED THE REQUIREMENTS FOR A CHAMPIONSHIP AFTER THE CLOSING OF ENTRIES MAY BE TRANSFERRED FROM ONE OF THE REGULAR CLASSES TO THE BEST OF BREED PROVIDING THIS TRANSFER IS MADE TO THE SUPERINTENDENT OR SHOW SECRETARY AT LEAST 30 MINUTES PRIOR TO THE START OF ANY REGULAR CONFORMATION JUDGING AT THAT SHOW.

NOTICE TO EXHIBITORS

A RECORDING FEE OF \$3.50 WILL BE REQUIRED FOR EACH DOG ENTERED IN ANY LICENSED OR MEMBER CLUB SHOW, OBEDIENCE TRIAL OR TRACKING TEST. THIS RECORDING FEE IS TO BE COLLECTED BY THE SHOW-GIVING CLUB AND PAID TO THE AMERICAN KENNEL CLUB. IF A DOG IS ENTERED IN MORE THAN ONE CLASS IN THE SHOW, THE RECORDING FEE IS TO BE COLLECTED ON THE FIRST ENTRY ONLY. (AMERICAN KENNEL CLUB RULE, CHAPTER 11, SECTION 2.). RALLY RECORDING FEE OF \$3.00 IS REQUIRED PER CLASS FOR EACH ENTRY OF EACH DOG (AMERICAN KENNEL CLUB RULE, CHAPTER 1, SECTION 3).

DOGS NEED BE AT SHOW ONLY AT SCHEDULED TIME OF JUDGING AND MAY LEAVE IMMEDIATELY THEREAFTER, UNLESS REQUIRED FOR FURTHER JUDGING.

AKC Rules, Regulations, Policies and Guidelines are available on the American Kennel Club Web site, www.akc.org

AGREEMENT

I (we) agree that the club holding this event has the right to refuse this entry for cause which the club shall deem sufficient. In consideration of the acceptance of this entry and of the holding of this event and of the opportunity to have the dog judged and to win prizes, ribbons, or trophies, I (we) agree to hold the AKC, the event-giving club, their members, directors, governors, officers, agents, superintendents or event secretary and the owner and/or lessor of the premises and any provider of services that are necessary to hold this event and any employees or volunteers of the aforementioned parties, and any AKC approved judge, judging at this event, harmless from any claim for loss or injury which may be alleged to have been caused directly or indirectly to any person or thing by the act of this dog while in or about the event premises or grounds or near any entrance thereto, and I (we) personally assume all responsibility and liability for any such claim; and I (we) further agree to hold the aforementioned parties harmless from any claim for loss, injury or damage to this dog.

Additionally, I (we) hereby assume the sole responsibility for and agree to indemnify, defend and save the aforementioned parties harmless from any and all loss and expense (including legal fees) by reason of the liability imposed by law upon any of the aforementioned parties for damage because of bodily injuries, including death at any time resulting therefrom, sustained by any person or persons, including myself (ourselves), or on account of damage to property, arising out of or in consequence of my (our) participation in this event, however such, injuries, death or property damage may be caused, and whether or not the same may have been caused or may be alleged to have been caused by the negligence of the aforementioned parties or any of their employees, agents, or any other persons. I (WE) AGREE THAT ANY CAUSE OF ACTION, CONTROVERSY OR CLAIM ARISING OUT OF OR RELATED TO THE ENTRY, EXHIBITION OR ATTENDANCE AT THE EVENT BETWEEN THE AKC AND THE EVENT-GIVING CLUB (UNLESS OTHERWISE STATED IN ITS PREMIUM LIST) AND MYSELF (OURSELVES) OR AS TO THE CONSTRUCTION, INTERPRETATION AND EFFECT OF THIS AGREEMENT SHALL BE SETTLED BY ARBITRATION PURSUANT TO THE APPLICABLE RULES OF THE AMERICAN ARBITRATION ASSOCIATION. HOWEVER, PRIOR TO ARBITRATION ALL APPLICABLE AKC BYLAWS, RULES, REGULATIONS AND PROCEDURES MUST FIRST BE FOLLOWED AS SET FORTH IN THE AKC CHARTER AND BYLAWS, RULES, REGULATIONS, PUBLISHED POLICIES AND GUIDELINES.

INSTRUCTIONS

- (Variety) If you are entering a dog of breed in which there are varieties for show purposes, please designate the particular variety you are entering, i.e., Cocker Spaniel (solid color black, ASCOB, parti-color), Beagles (not exceeding 13 in., over 13 in. but not exceeding 15 in.), Dachshunds (longhaired, smooth, wirehaired), Coonies (rough, smooth), Bull Terriers (colored, white), Manchester Terriers (standard, toy), Chihuahuas (smooth coat, long coat), English Toy Spaniels (King Charles and Ruby, Blenheim and Prince Charles), Poodles (toy, miniature, standard).
- The following categories of dogs may be entered and shown in Best of Breed competition: Dogs that are Champions of Record and dogs which, according to their owners' records, have completed the requirements for a championship, but whose championships are unconfirmed. The showing of unconfirmed Champions in Best of Breed competition is limited to a period of 90 days from the date of the show where the dog completed the requirements for a championship.
- (Event Class) Consult the classification in this premium list. If the event class in which you are entering your dog is divided, then, in addition to designating the class, specify the particular division of the class in which you are entering your dog, i.e., age division, color division, weight division.
- A dog must be entered in the name of the person who actually owned it at the time entries for an event closed. If a registered dog has been acquired by a new owner it must be entered in the name of its new owner in any event for which entries closed after the date of acquisition, regardless of whether the new owner has received the registration certificate indicating that the dog is recorded in his name. State on entry form whether transfer application has been mailed to the AKC. (For complete rules, refer to Chapter 11, Section 3.)

If this entry is for Junior Showmanship, please give the following information:

JUNIOR SHOWMANSHIP _____ JR.'S DATE OF BIRTH _____

AKC JUNIOR HANDLER NUMBER

The above number MUST be included. Should you not have your Junior Handler number, this may be obtained from the American Kennel Club, Phone: (813) 816-3776.

By signing the entry form I (we) certify that the Junior Showman does not now, and will not at any time, act as an agent/handler for pay while continuing to compete in Junior Showmanship.

ADDRESS _____

CITY _____ STATE _____ ZIP _____

If Junior Handler is not the owner of the dog identified on the face of this form, what is the relationship of the Junior Handler to the Owner? _____

AEN999 (2/06)



AMERICAN KENNEL CLUB OFFICIAL ENTRY FORM

THE GERMAN SHEPHERD DOG CLUB OF GREATER CINCINNATI, INC.

AM & PM GSD Specialty and 2 DAYS of All Breed Obedience / Rally Trail
Friday, May 28, 2010 -- # 2010173901 Obedience -- # 2010173903 Rally

Saturday, May 29, 2010 -- # 2010173902 Obedience -- # 2010173904 Rally

Saturday, May 29, 2010 -- AM # 2010173901 ... Conformation ,

Saturday, May 29, 2010 -- PM # 2010173902 ... Conformation & Jr. Showmanship

Location: Blue Ribbon Dog Training Academy, LLC, 3548 Jackson Pike, Williamsburg, Oh., 45176

Entries Close: Wednesday, May 5, 2010 at 5:00 pm. After which time they will not be accepted, Cancelled, or substituted except as provided in Section 13, Chapter 6, of the Dog Show Rules. Entry Fees: \$25.00 for the first entry of each dog in all Regular Classes except Puppy & Non-Regular Classes, which is \$15.00. Additional entry of the same dog is \$15.00. Junior Showmanship is \$5.00 if dog is not entered in any other class. Mail entries with fees to: Janet Wurzelbacher, P.O. Box 13333, Hamilton, Oh., 45013

Make Check payable to: The German Shepherd Dog Club of Greater Cincinnati, Inc. ENCLOSE \$.....FOR ENTRY FEES

IMPORTANT-Read Carefully Instructions on Reverse Side Before Filling Out. Numbers in the boxes indicate sections of the instructions relevant to the information needed in that box (PLEASE PRINT)

BREED		VARIETY 1		SEX
DOG 2 3 SHOW CLASS	CLASS 3 DIVISION Weight, color, etc.			
ADDITIONAL CLASSES	OBEDIENCE CLASS	RALLY CLASS (Jump Height)	JR. SHOWMANSHIP CLASS	
NAME OF (See Back) JUNIOR HANDLER (if any)				JR. HANDLER NUMBER
FULL NAME OF DOG				
Enter number here				DATE OF BIRTH
<input type="checkbox"/> AKC* REG NO. <input type="checkbox"/> AKC LITTER NO. <input type="checkbox"/> ILP NO. <input type="checkbox"/> FOREIGN REG NO & COUNTRY				PLACE OF BIRTH <input type="checkbox"/> USA <input type="checkbox"/> Canada <input type="checkbox"/> Foreign
BREEDER				
SIRE				
DAM				
ACTUAL OWNER(S) _____ 4 (Please Print)				
OWNER'S ADDRESS _____				
CITY _____ STATE _____ ZIP _____				

NAME OF OWNER'S AGENT
(IF ANY) AT THE SHOW _____

I CERTIFY that I am the actual owner of the dog, or that I am the duly authorized agent of the actual owner whose name I have entered above. In consideration of the acceptance of this entry, I (we) agree to abide by the rules and regulations of The American Kennel Club in effect at the time of this event, and by any additional rules and regulations appearing in the premium list for this event, and further agree to be bound by the "Agreement" printed on the reverse side of this entry form. I (we) certify and represent that the dog entered is not a hazard to persons or other dogs. This entry is submitted for acceptance on the foregoing representation and Agreement. I (we) agree to conduct myself (ourselves) in accordance with all such Rules and Regulations (including all provisions applying to discipline) and to abide by any decisions made in accord with them.

SIGNATURE of owner or his agent
duly authorized to make this entry _____

TELEPHONE# _____

E-MAIL Address (An acknowledgment or receipt of entry may be sent to this e-mail address):

AEN999 (2/06)